

Industry Rates (20%)  
Valid 1 April 2025 – 31 March 2026

BRIDGECLIMB  
SYDNEY

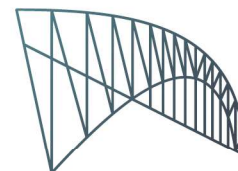

+61 2 8274 7773 | [inbound@bridgeclimb.com](mailto:inbound@bridgeclimb.com)

Eora Country | 3 Cumberland Street, The Rocks, Sydney NSW 2000

Feliz Puente Pty Ltd | ABN: 79 625 999 877

[bridgeclimb.com](https://www.bridgeclimb.com)



**SUMMIT (3 hrs)** - <https://www.bridgeclimb.com/climbs-prices/summit>

**INSIDER\*\* (2 1/2 hrs)** - <https://www.bridgeclimb.com/climbs-prices/insider>

**MANDARIN \*\*\* (2 1/2 HRS)** - <https://www.bridgeclimb.com/climbs-prices/mandarin-climb>

STANDARD PERIOD MIDWEEK	ADULT - MIDWEEK		CHILD - MIDWEEK (8-15 years inclusive)	
	Retail Rates	Net Rates	Retail Rates	Net Rates
Time of Day				
Day	\$364.00	\$291.20	\$155.00	\$124.00
Twilight	\$394.00	\$315.20	\$225.00	\$180.00
Night	\$298.00	\$238.40	\$155.00	\$124.00
Dawn*	\$404.00	\$323.20	\$245.00	\$196.00

STANDARD PERIOD WEEKEND	ADULT - WEEKEND		CHILD - WEEKEND (8-15 years inclusive)	
	Retail Rates	Net Rates	Retail Rates	Net Rates
Time of Day				
Day	\$374.00	\$299.20	\$161.00	\$128.80
Twilight	\$404.00	\$323.20	\$231.00	\$184.80
Night	\$308.00	\$246.40	\$161.00	\$128.80
Dawn*	\$414.00	\$331.20	\$251.00	\$200.80

**Standard Retail Prices** apply on all operational days **excluding peak period** from Thursday 25<sup>th</sup> December 2025 to Sunday 4<sup>th</sup> January 2026 inclusive.

Peak period rates outlined below.

*\*Dawn Climbs depart early morning to ensure climbers are on the Bridge as the sun rises. Operates on Summit route only. Dawn Climbs are available on the first Saturday of each month. During summer Dawn Climbs are available twice a month. Please contact BridgeClimb for availability*

*\*\* Insider Climbs are scheduled on Day Climbs, some Twilight Climbs and are available at other times for groups on request.*

*\*\*\* Mandarin Climbs have limited departures. Please contact BridgeClimb for availability*

### ULTIMATE (3 1/2 hrs)

*The entire Bridge from South to North, and back again*

<https://www.bridgeclimb.com/climbs-prices/ultimate>

STANDARD PERIOD MIDWEEK	ADULT - MIDWEEK		CHILD - MIDWEEK (8-15 years inclusive)	
Time of Day	Retail Rates	Net Rates	Retail Rates	Net Rates
Day	\$384.00	\$307.20	\$225.00	\$180.00

STANDARD PERIOD WEEKEND	ADULT - WEEKEND		CHILD - WEEKEND (8-15 years inclusive)	
Time of Day	Retail Rates	Net Rates	Retail Rates	Net Rates
Day	\$394.00	\$315.20	\$231.00	\$184.80

Not available during our peak period from Thursday 25<sup>th</sup> December 2025 to Sunday 4<sup>th</sup> January 2026 inclusive.

### BURRAWA (3 hrs) - Indigenous storytelling experience

<https://www.bridgeclimb.com/climbs-prices/burrawa>

STANDARD PERIOD MIDWEEK	ADULT - MIDWEEK		CHILD - MIDWEEK (8-15 years inclusive)	
Time of Day	Retail Rates	Net Rates	Retail Rates	Net Rates
Day	\$364.00	\$291.20	\$155.00	\$124.00

STANDARD PERIOD WEEKEND	ADULT - WEEKEND		CHILD - WEEKEND (8-15 years inclusive)	
Time of Day	Retail Rates	Net Rates	Retail Rates	Net Rates
Day	\$374.00	\$299.20	\$161.00	\$128.80

Includes a \$20 donation to our charity partner Tribal Warrior  
Limited departures. Please contact BridgeClimb for availability..

### THE VIVID CLIMB (3 hrs)

<https://www.bridgeclimb.com/packages-and-occasions/vivid-packages>

MIDWEEK	ADULT - MIDWEEK		CHILD - MIDWEEK (8-15 years inclusive)	
Time of Day	Retail Rates	Net Rates	Retail Rates	Net Rates
Night	\$364.00	\$291.20	\$155.00	\$124.00

WEEKEND	ADULT - WEEKEND		CHILD - WEEKEND (8-15 years inclusive)	
Time of Day	Retail Rates	Net Rates	Retail Rates	Net Rates
Night	\$374.00	\$299.20	\$161.00	\$128.80

- Operates on Summit Climb route
- Operates Daily 23<sup>rd</sup> May to 14<sup>th</sup> June 2025 inclusive

## BRIDGECLIMB SYDNEY PEAK RATES 2025 - 2026

Valid Thursday 25<sup>th</sup> December 2025 to Sunday 4<sup>th</sup> January 2026 inclusive

### SUMMIT (3 hrs) & INSIDER (2 1/2 hrs)

PEAK PERIOD MIDWEEK	ADULT - MIDWEEK		CHILD - MIDWEEK (8-15 years inclusive)	
Time of Day	Retail Rates	Net Rates	Retail Rates	Net Rates
Day	\$394.00	\$315.20	\$185.00	\$148.00
Twilight	\$424.00	\$339.20	\$255.00	\$204.00
Night	\$328.00	\$262.40	\$185.00	\$148.00
Dawn**	\$434.00	\$347.20	\$275.00	\$220.00

PEAK PERIOD WEEKEND	ADULT - WEEKEND		CHILD - WEEKEND (8-15 years inclusive)	
Time of Day	Retail Rates	Net Rates	Retail Rates	Net Rates
Day	\$404.00	\$323.20	\$191.00	\$152.80
Twilight	\$434.00	\$347.20	\$261.00	\$208.80
Night	\$338.00	\$270.40	\$191.00	\$152.80
Dawn**	\$444.00	\$355.20	\$281.00	\$224.80

### BURRAWA (3 hrs) - Aboriginal storytelling experience

<https://www.bridgeclimb.com/climbs-prices/burrawa>

PEAK PERIOD MIDWEEK	ADULT - MIDWEEK		CHILD - MIDWEEK (8-15 years inclusive)	
Time of Day	Retail Rates	Net Rates	Retail Rates	Net Rates
Day	\$394.00	\$315.20	\$185.00	\$148.00

PEAK PERIOD WEEKEND	ADULT - WEEKEND		CHILD - WEEKEND (8-15 years inclusive)	
Time of Day	Retail Rates	Net Rates	Retail Rates	Net Rates
Day	\$404.00	\$323.20	\$191.00	\$152.80

- Includes a \$20 donation to our charity partner Tribal Warrior
- Operates on Tuesdays and Sundays at 1135 and on other days for groups on request. Please contact BridgeClimb for group availability.

### STANDARD CLIMB INCLUSIONS

- Dedicated Climb Leader for every 14 Climbers
- Group Photo
- Digital Certificate of Achievement
- BridgeClimb Cap
- Bridge and Sydney history commentary
- 360 degree views of Sydney

## VARIATIONS TO DAILY OPERATIONS

Variations to daily operations known to BridgeClimb at the time of publication of this rates sheet are as follows:

25 December 2025	Limited Operations
29 December 2025	Not all Climb products available
30 December 2025	No Operations
31 December 2025	No Operations
1 January 2026	Operations commence from 0900. Not all Climb products available

## TIME OF DAY DEFINITIONS



Dawn	Climbs depart early morning to allow for climbers to be on the Bridge to see the sun rise. Limited departures.
------	--



Day	Climbs depart after Dawn Climbs throughout the Day, and prior to Twilight Climbs.
-----	---



Twilight	Climbs depart in the afternoon so that climbers are on the Bridge for Twilight, when the sun is setting.
----------	--



Night	Climbs depart after Twilight Climbs.
-------	--------------------------------------

## CONDITIONS

Health and Safety is vitally important; In light of this, **contact details for all Climbers must be supplied to BridgeClimb Sydney at time of booking** in order that we can communicate important health and safety guidelines to your clients prior to their Climb including our [declaration form](#) which they will be required to complete. **If you are unable to provide us with this information, it is your responsibility to inform your clients of these important guidelines. If they arrive and are unable to Climb due to not meeting our health and safety criteria, we will not be held liable for any credit or refunds requested.**

### These guidelines include but are not limited to:

- If climbers are under 24 weeks pregnant, they can Climb with a BridgeClimb [Certificate of Fitness](#) signed by their GP. Please ask them to download this form to bring with them on the day. Women over 24 weeks pregnant cannot participate in the Tours. *(Please note the Certificate of Fitness must have been completed within the last three months prior to your Climb date).*
- If climbers are 75 years of age, or older, they can Climb with a BridgeClimb [Certificate of Fitness](#) signed by their GP. Please ask them to download this form to bring it with them on the day. *(Please note the Certificate of Fitness must have been completed within the last three months prior to your Climb date).*
- Climbers must have a blood-alcohol reading below 0.05 to climb (the same as if you are driving in Australia)
- We provide FREE secure lockers for your clients to keep their personal belongings in, including phones, cameras and GoPros. Our Climb Leaders are multi-talented human beings and as well as being exceptional tour guides, they're also trained to capture photos of your clients during their Climb. For safety and security reasons, cameras, video technology, mobile devices, jewellery, watches and other loose items are prohibited on the Climb.
- We are an all-weather activity; we will equip your clients with all the outdoor gear they'll need for their Climb, based on the day's weather conditions. In case of extreme weather like electrical storms or during times of extremely high wind, Climbs may be postponed.

- Health and Safety Exceptions: We do our best to help everyone Climb, after all, we want everyone to take part in this amazing experience, however there are some things that will prevent you from participating, including:
  - a. A fit or seizure in the last six months
  - b. Broken bones
  - c. If you are more than 24 weeks pregnant
  - d. You're under 8 years of age
  - e. You're under 1.2 metres tall
  - f. If you're showing symptoms of COVID-19 please do not visit BridgeClimb, instead seek medical attention. Call your doctor, your local Emergency Department or health direct on 1800 022 222 and avoid contact with others. If you do arrive at BridgeClimb with flu-like symptoms, you may be refused entry to BridgeClimb – please see our terms and conditions.
- BridgeClimb acts in-line with the current NSW Health orders so please make sure your clients are eligible to visit BridgeClimb. Our visitation eligibility is outlined on our [website](#)
- All prices are GST inclusive and quoted in Australian dollars
- This document is to be read in conjunction with terms of business available at <http://www.bridgeclimb.com/terms/>
- Every 3 Children aged 8-15 years inclusive must be accompanied by one adult Participant on all climbs
- Climb rates and periods are subject to change and at the discretion of BridgeClimb.
- BridgeClimb may be able to offer interpreter services in certain languages, however, should a group require interpreter services not available from BridgeClimb, 1 FOC per 14 fully paid guests for every official Tour Leader or Tour Guide can be requested at BridgeClimb's discretion. FOC is not available during peak period.

## ADDITIONAL RESOURCES

We have our agent resource available to you; [BridgeClimb Connect](#), which is a 'one stop shop' for partners, connecting you to all things BridgeClimb! Essential updates, product information, useful tools and resources are all located in the one spot!

This page will of course never be "finished" as we will be constantly updating it with new content, collateral and campaign information going forward as things evolve. If you require product information, copy, images, video, climb time schedules, health and safety essentials, PL insurance docs etc. they can all be found on this page.

## VARIATION AND CANCELLATION POLICY

Once Climbs have been reserved, any change to the Climb date, time or number of Participants must be requested in writing.

Table 1 and Table 2 below set out the timing of payments, including deposits required, and any fees payable relating to any variation or cancellation of Climbs

**TABLE 1:**  
**Payment, Cancellation and Variation for reservations of 1 to 14 Participants**

Days to Climb	Payment	Terms and Conditions for changes
14 days or more	100% at time of reservation or change	No cancellation fees if changed / cancelled 14 days or more prior to climb
4 -13 days inclusive	100% at time of reservation or change	\$25 per adult ticket charged for each Climb cancelled. Changes may be made to the Climb date or time for a fee of \$30 per booking.
3 days (72 hours) or less	100% at time of reservation	50% fee charged for each Climb cancelled. Changes may be made to the Climb date or time for a fee of \$100 per booking.
All fees will be invoiced at the time they are incurred. For Buyers with credit terms, invoicing for Climbs will occur on the day prior to the Climb date.		
All fees will be charged at the time they are incurred. For Buyers who have completed a Credit Card Authorisation Form, processing of payment will occur at the time of booking or 14 days prior to the Climb date whichever is the later. Please note that for payments made by credit card a surcharge will be applied.		

**TABLE 2:**  
**Payment, Cancellation and Variation for reservations of 15 to 200 Participants**

Days to Climb	Non-Refundable Deposit	Final Payment And Participants	Terms and Conditions for changes
15 Days or more	50% at time of reservation or 3 months from Climb date whichever is the later	Balance of payment and final number of Participants due 14 days prior to Climb	No cancellation fees charged if changes made more than 15 days prior to climb. No part of the deposit will be refunded if number of Participants drops below 50% of the original number of Participants booked.
14 days or less	100% at time of reservation	N/A	100% fee charged for each Climb cancelled. No changes permitted to Climb date or time.
All fees will be invoiced at the time they are incurred. For Buyers with credit terms, invoicing of non-refundable deposits will occur at the time of the reservation or 3 months prior to the Climb date whichever is the later and the balance 14 days prior to the Climb date.			
All fees will be charged at the time they are incurred. For Buyers who have completed a Credit Card Authorisation Form, processing of payment will occur in accordance with the Table 2 above. Please note that for payments made by credit card a surcharge will be applied.			

Please note: Payment, Cancellation and Variation policy for reservations of 201+ Participants will be done by negotiation using the parameters set out in Table 2 as a guide.